

1811

Light Cycle Action Stand

117 pieces

A custom model design
by Jason Allemann

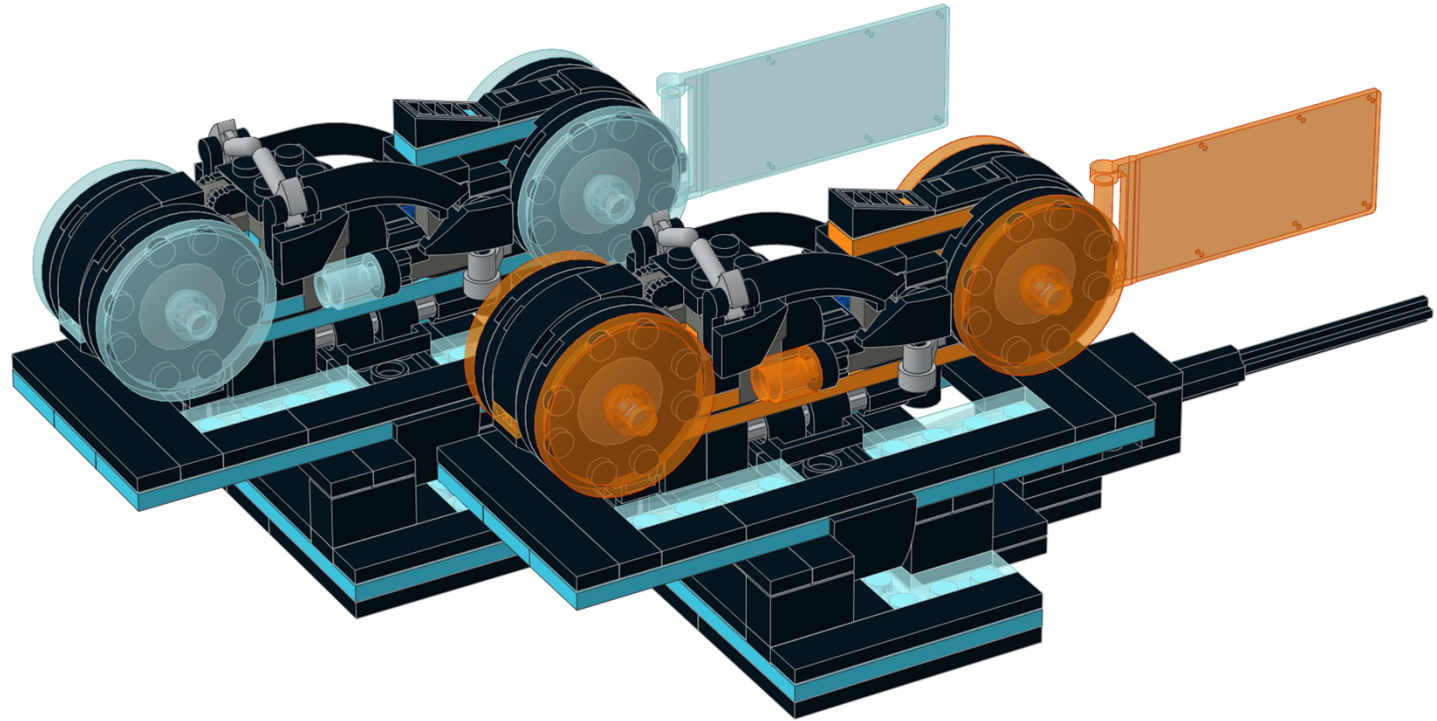

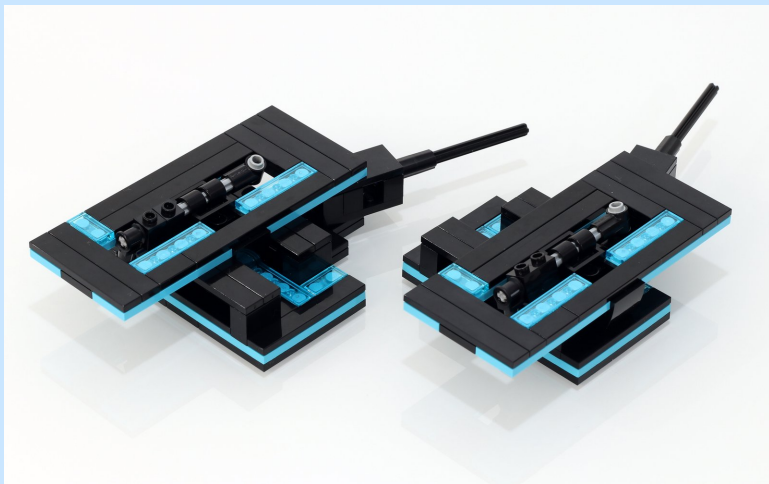

This model expands the display stand that comes in set 21314 TRON: Legacy so that you can display the light cycles in more dynamic poses.

In addition to the parts listed at the end of these instructions, you will also need the parts from the stand included in the set.

For more information about this model, or to see more of our custom model designs, visit jkbrickworks.com.

You can also find us at facebook.com/JKBrickworks or follow @jasonallemann on Twitter and Instagram.

© 2018 Jason Allemann



These instructions and the design depicted are made freely available for personal use, and are licensed under the *Creative Commons Attribution-NonCommercial 4.0 International License*.

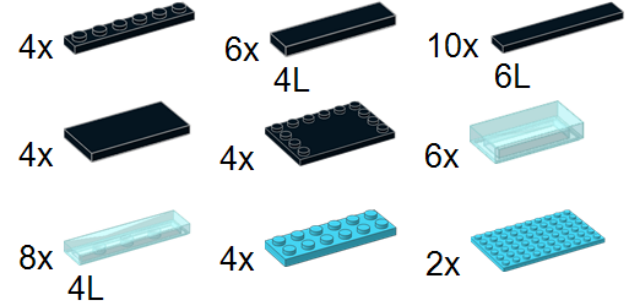
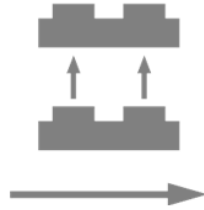
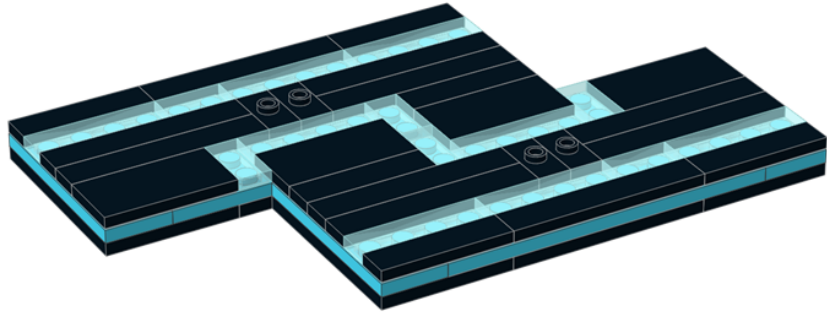

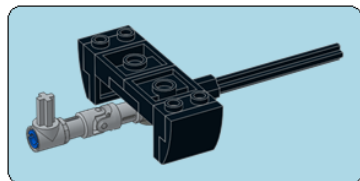

x2

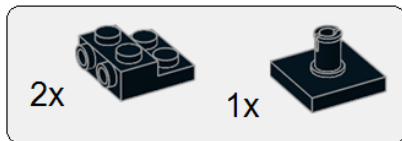

1

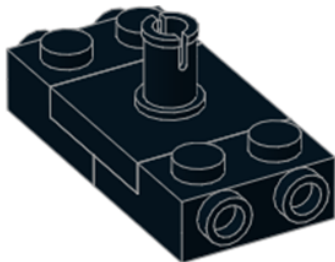

2

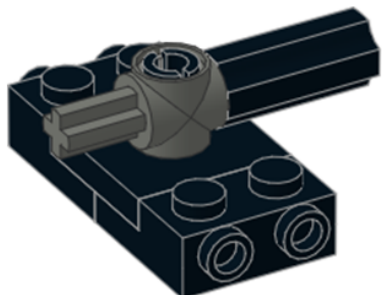

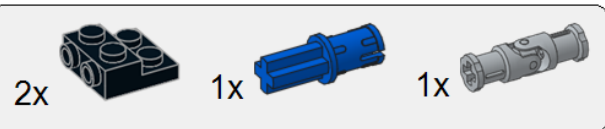

3

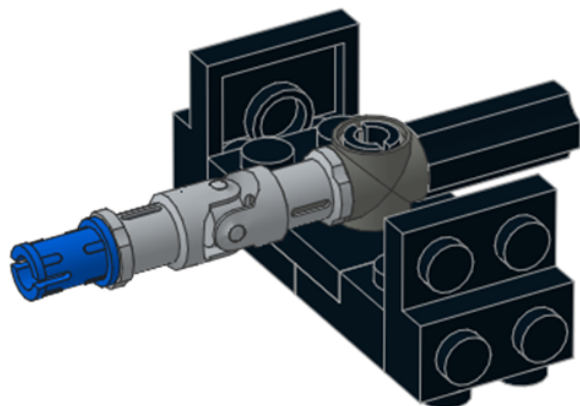

4

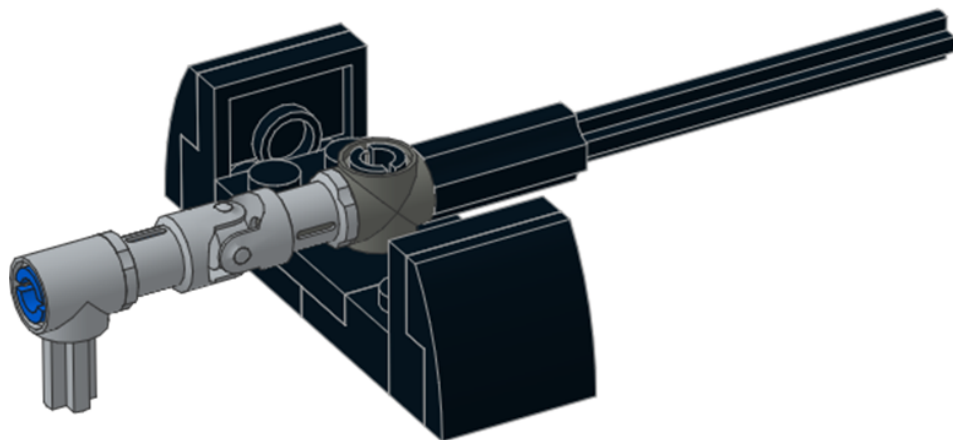

x2

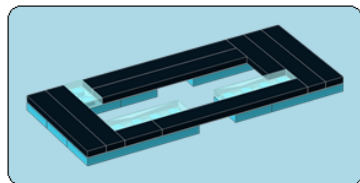

x2

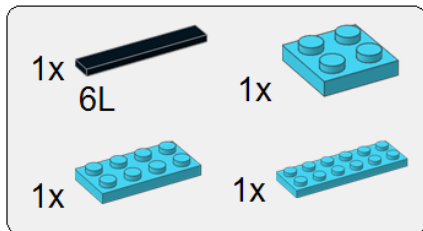

1

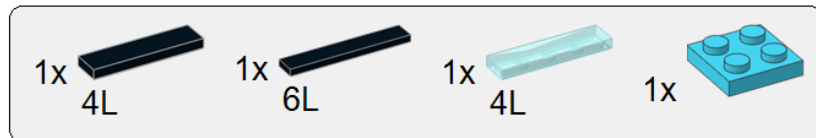
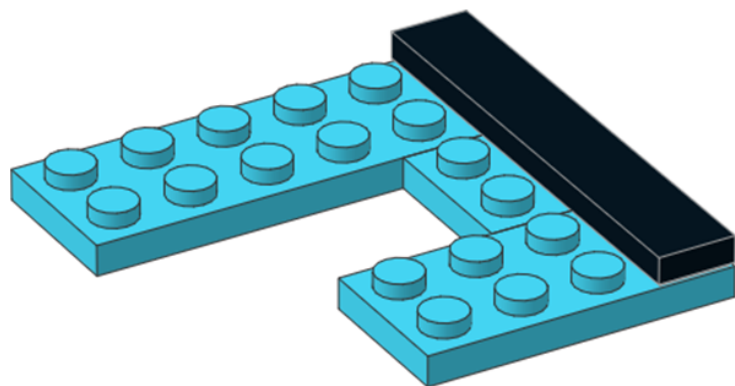

2

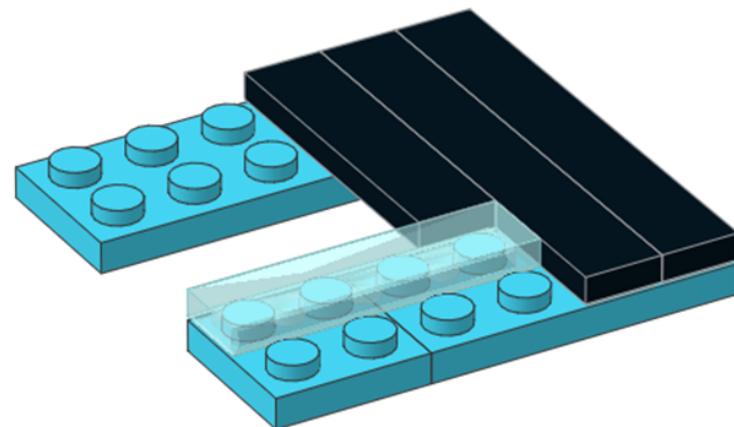

2x 8L 1x 1x 1x

3

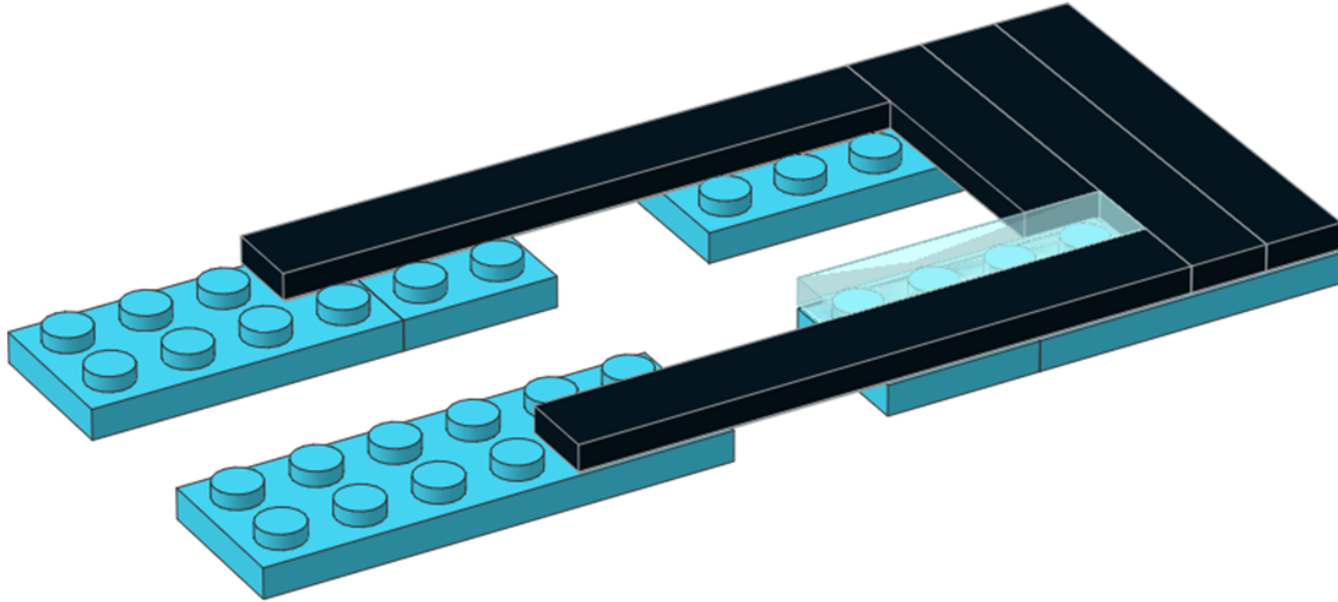



4

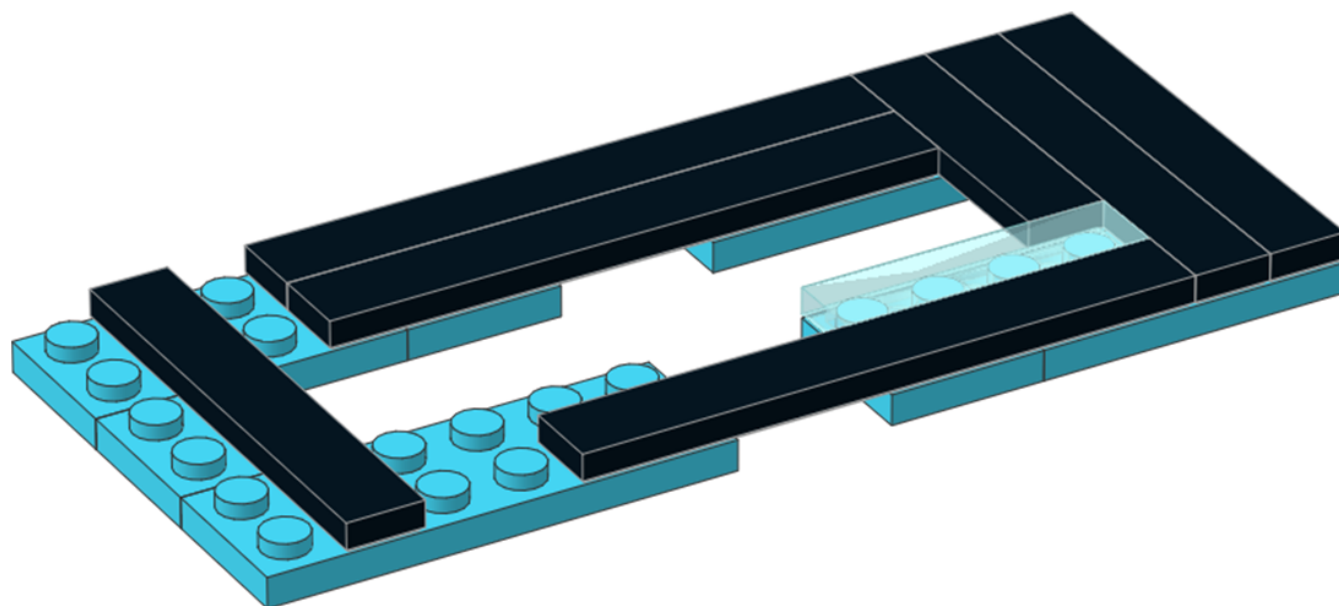

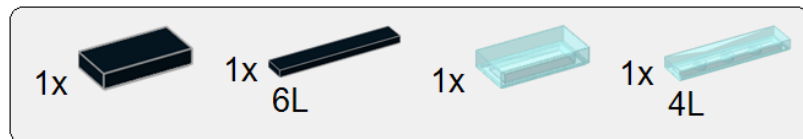

5

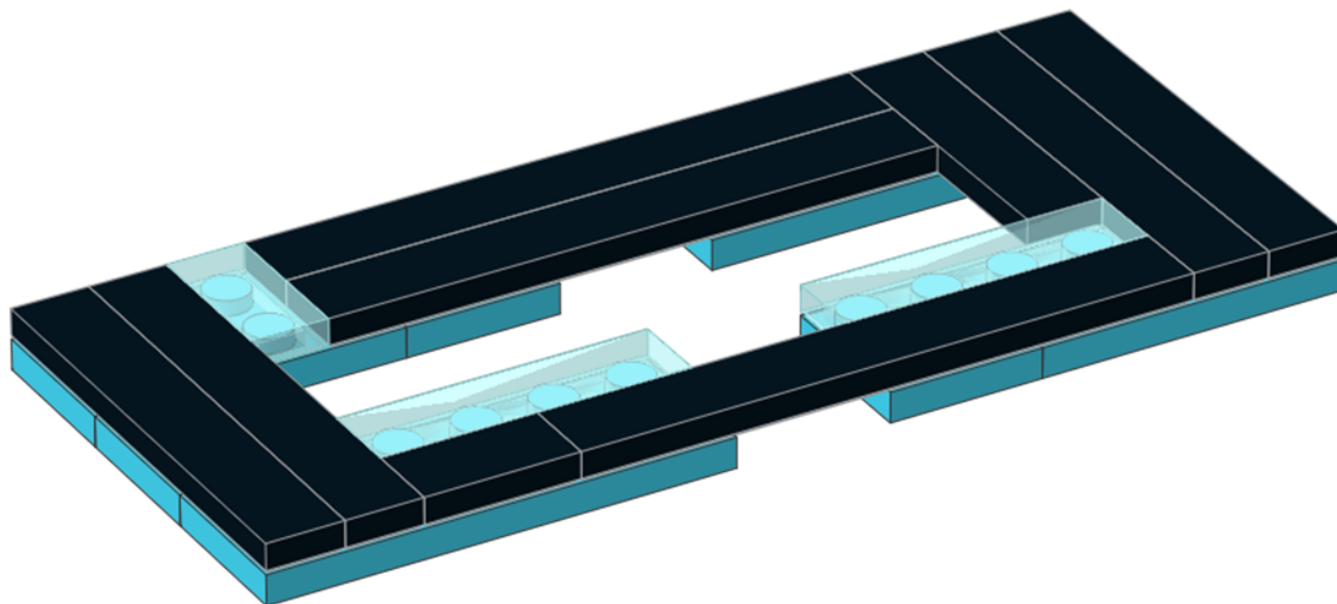

x2

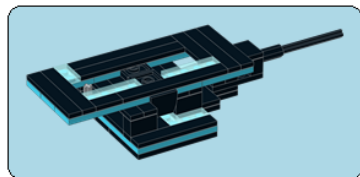

1

x2

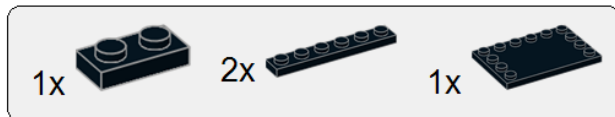
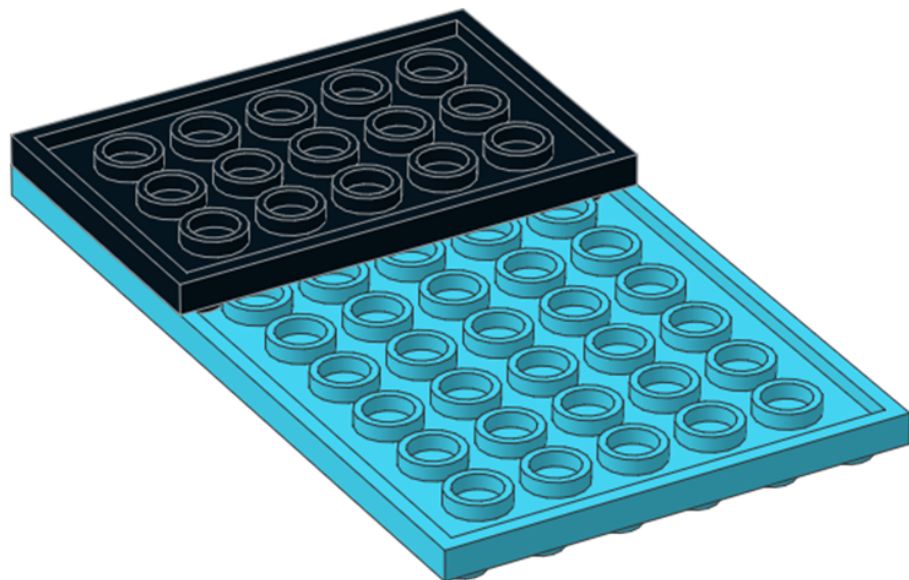

2

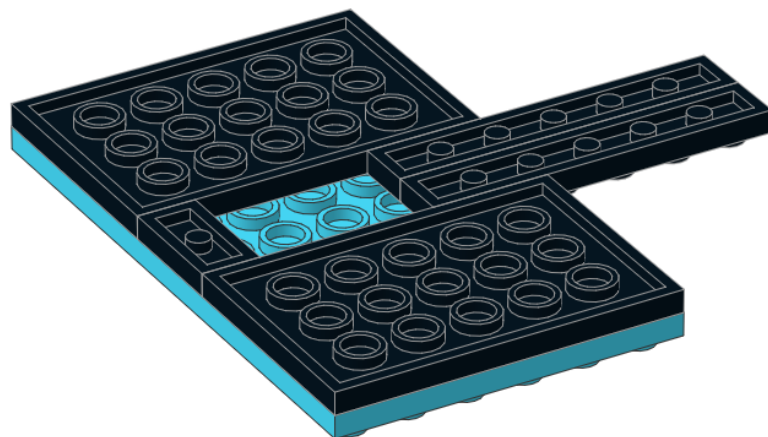



3

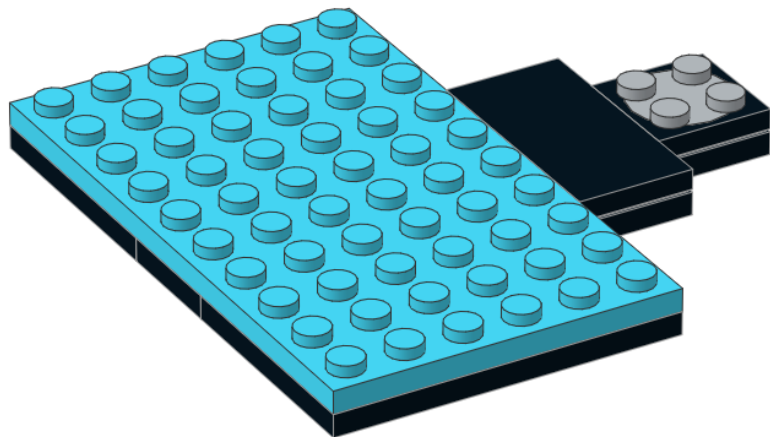

4

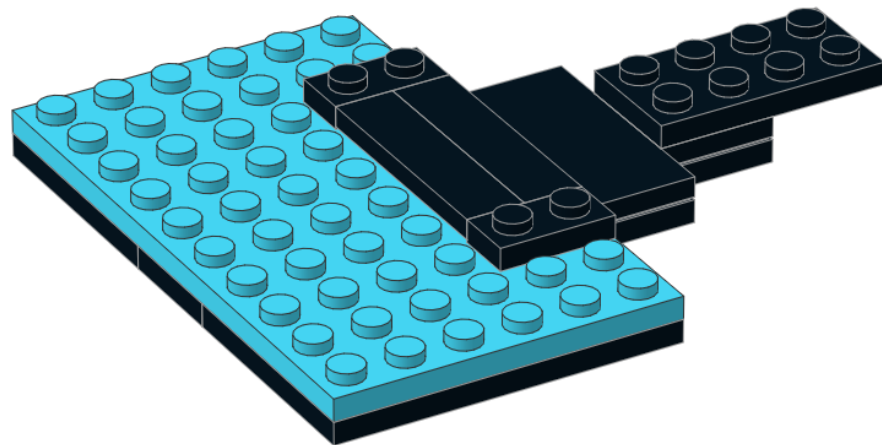

1x 8L 2x 2x 4L

5

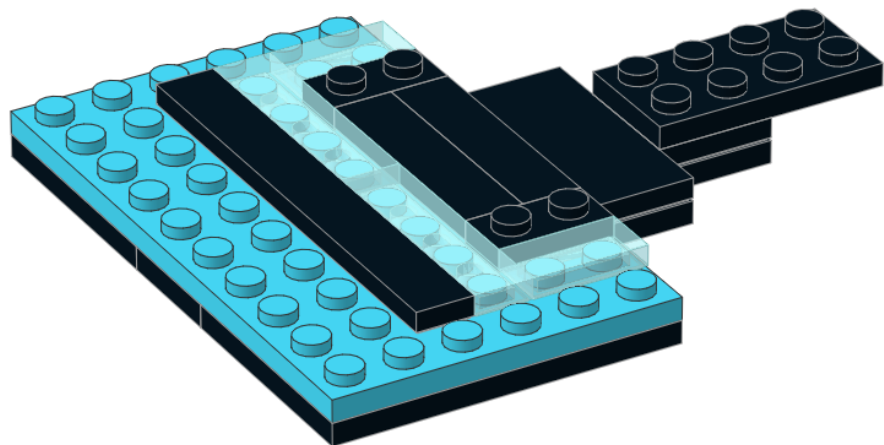

2x 4x 6L

6

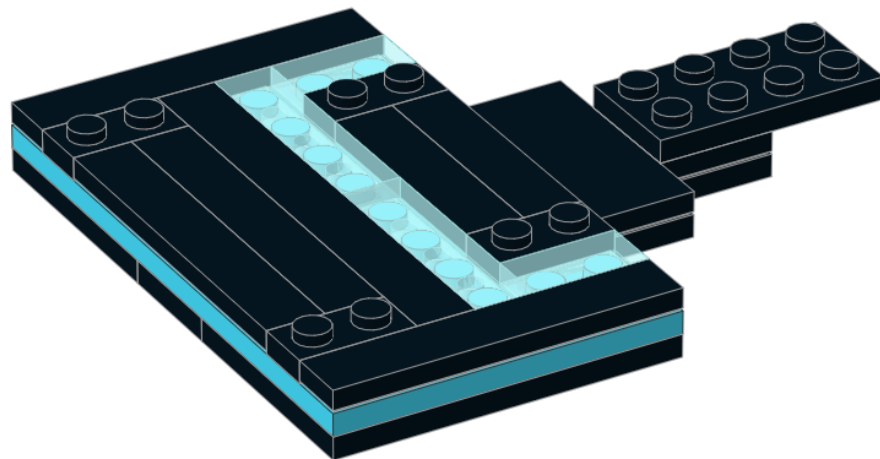



7

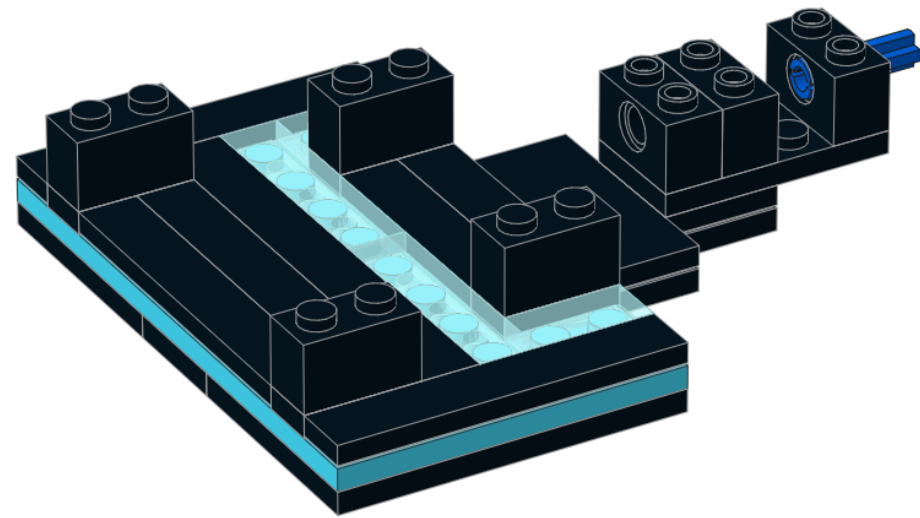

8

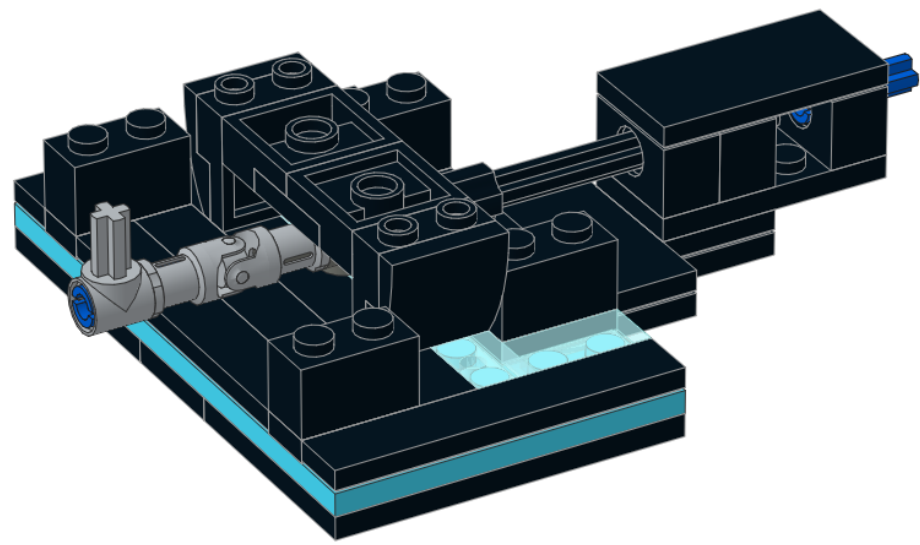



9

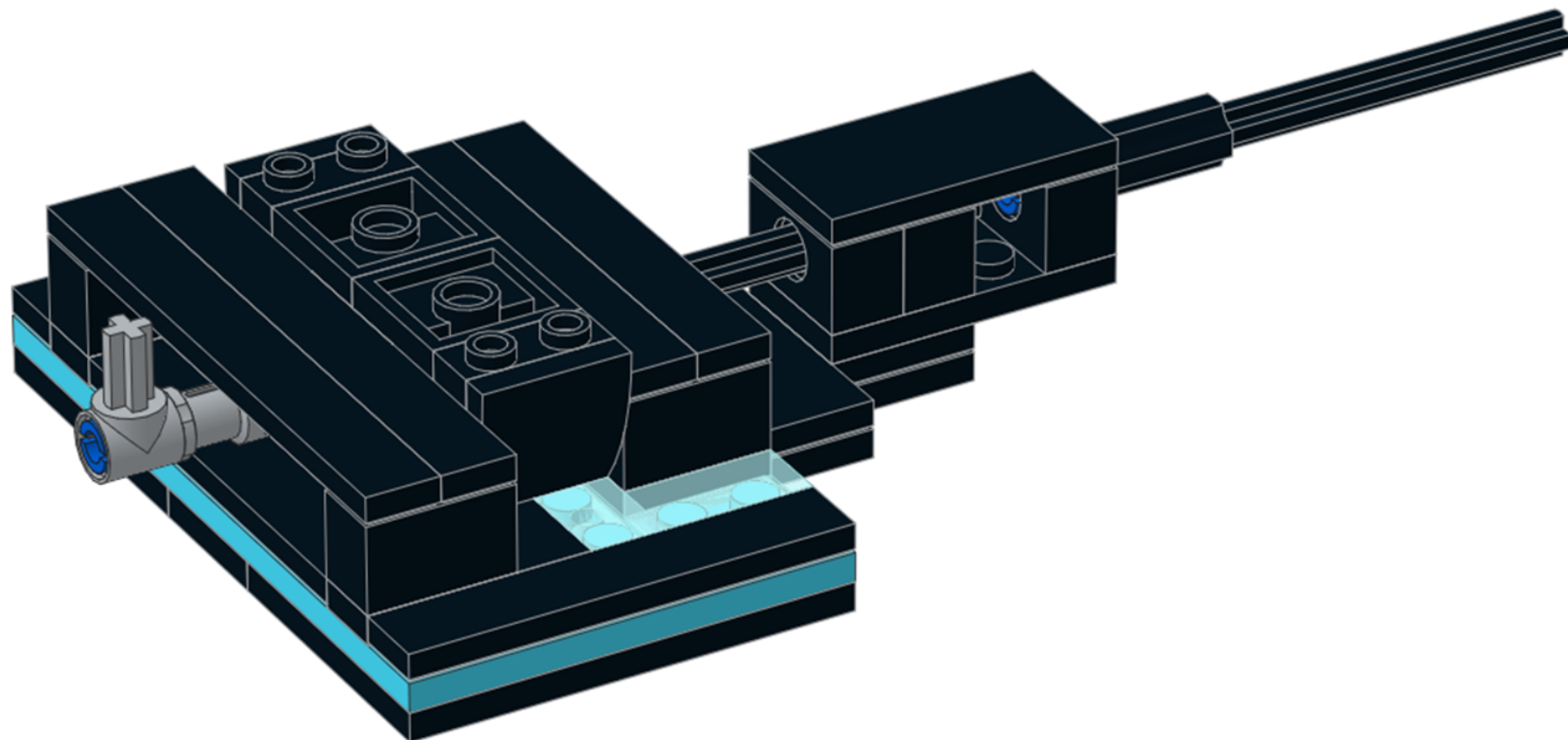

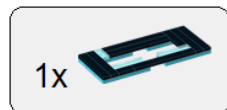

10

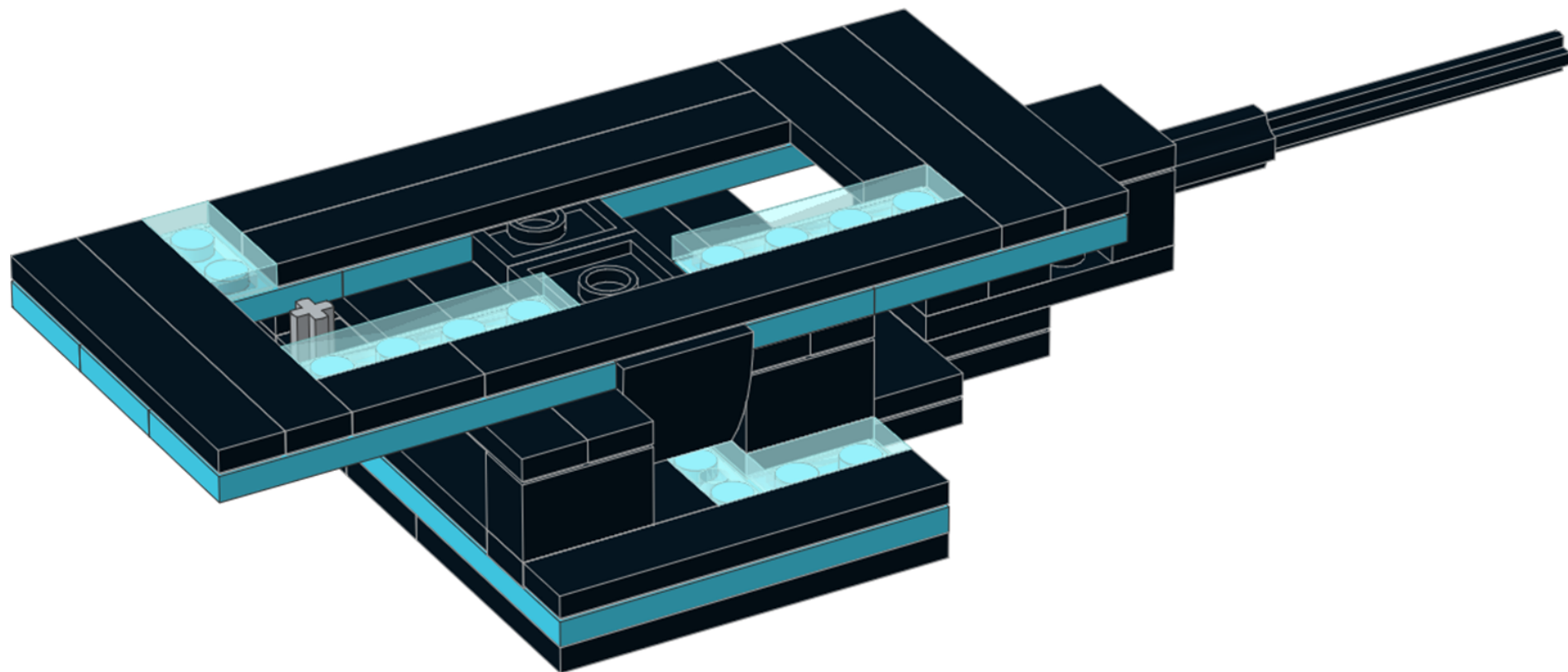

x2

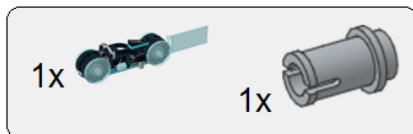
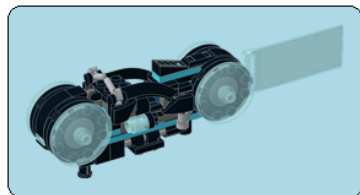

1

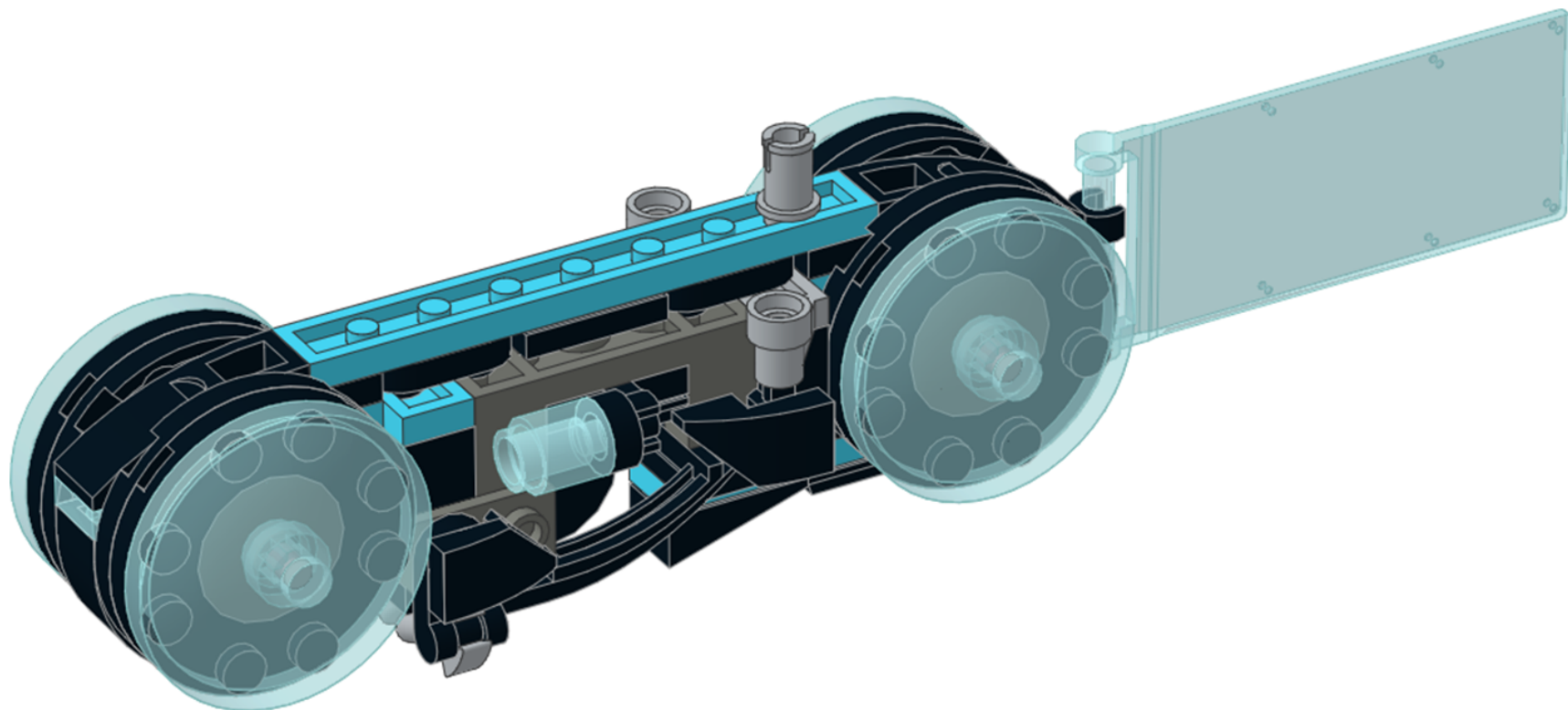

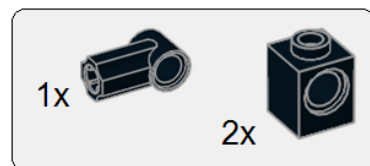

2

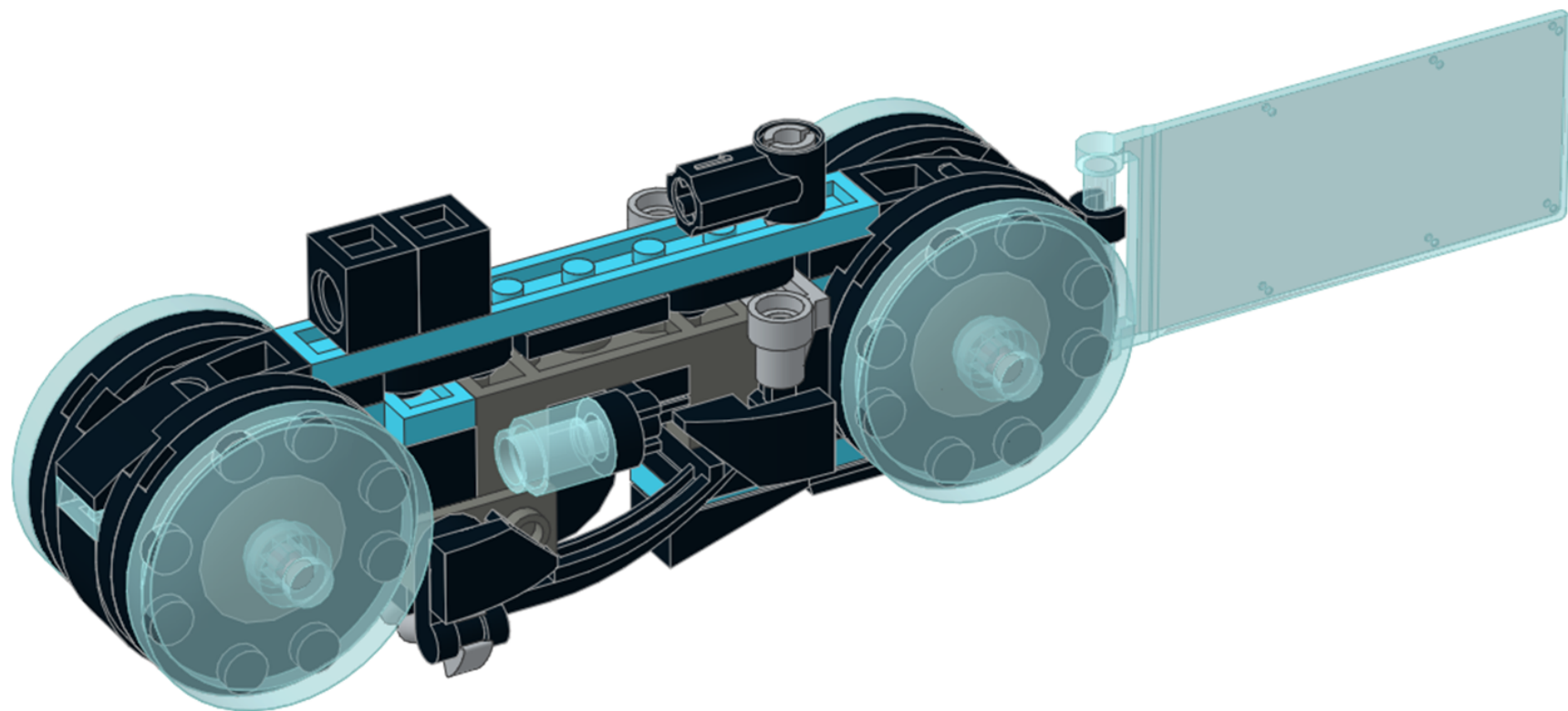



3

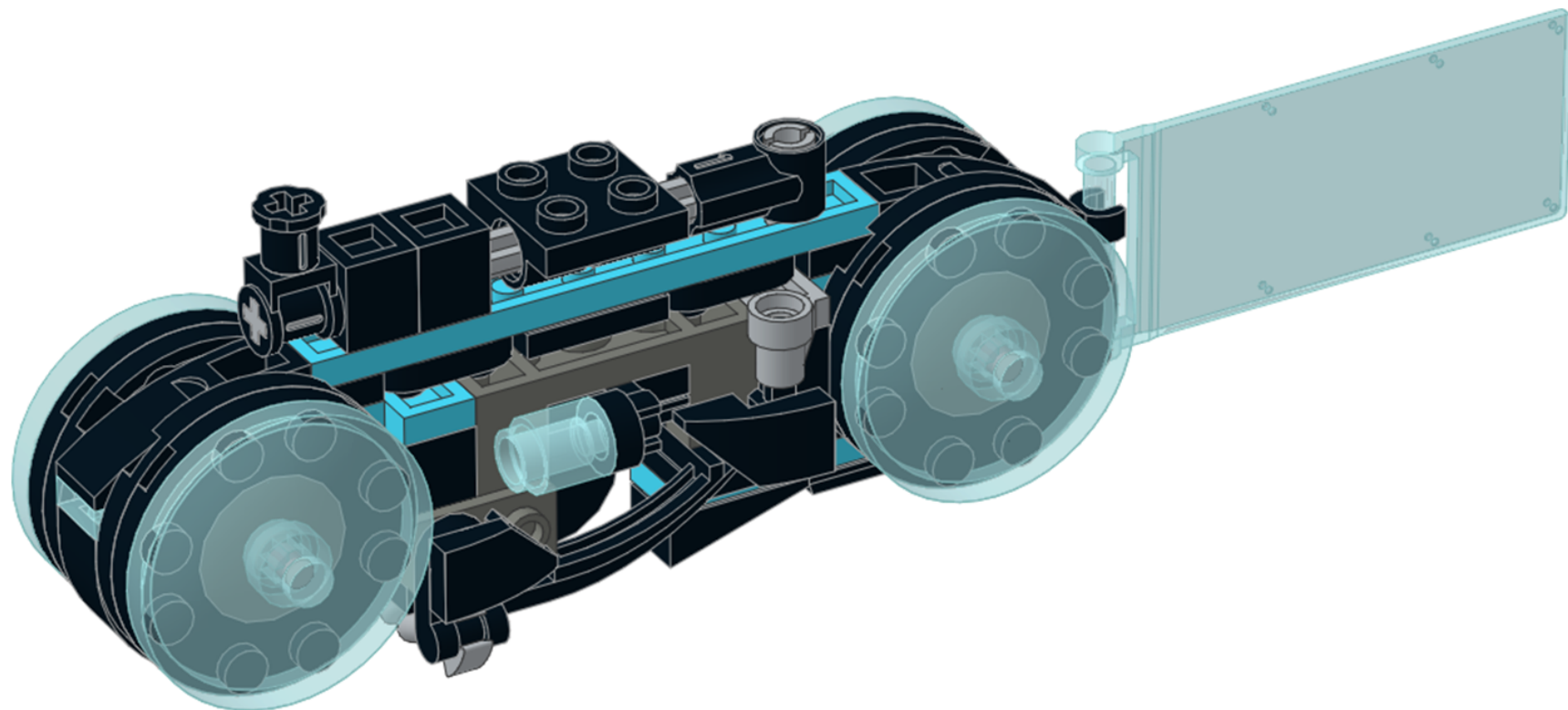

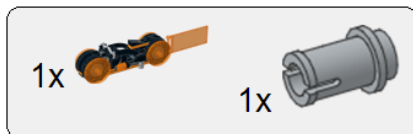
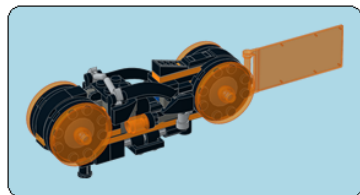

1

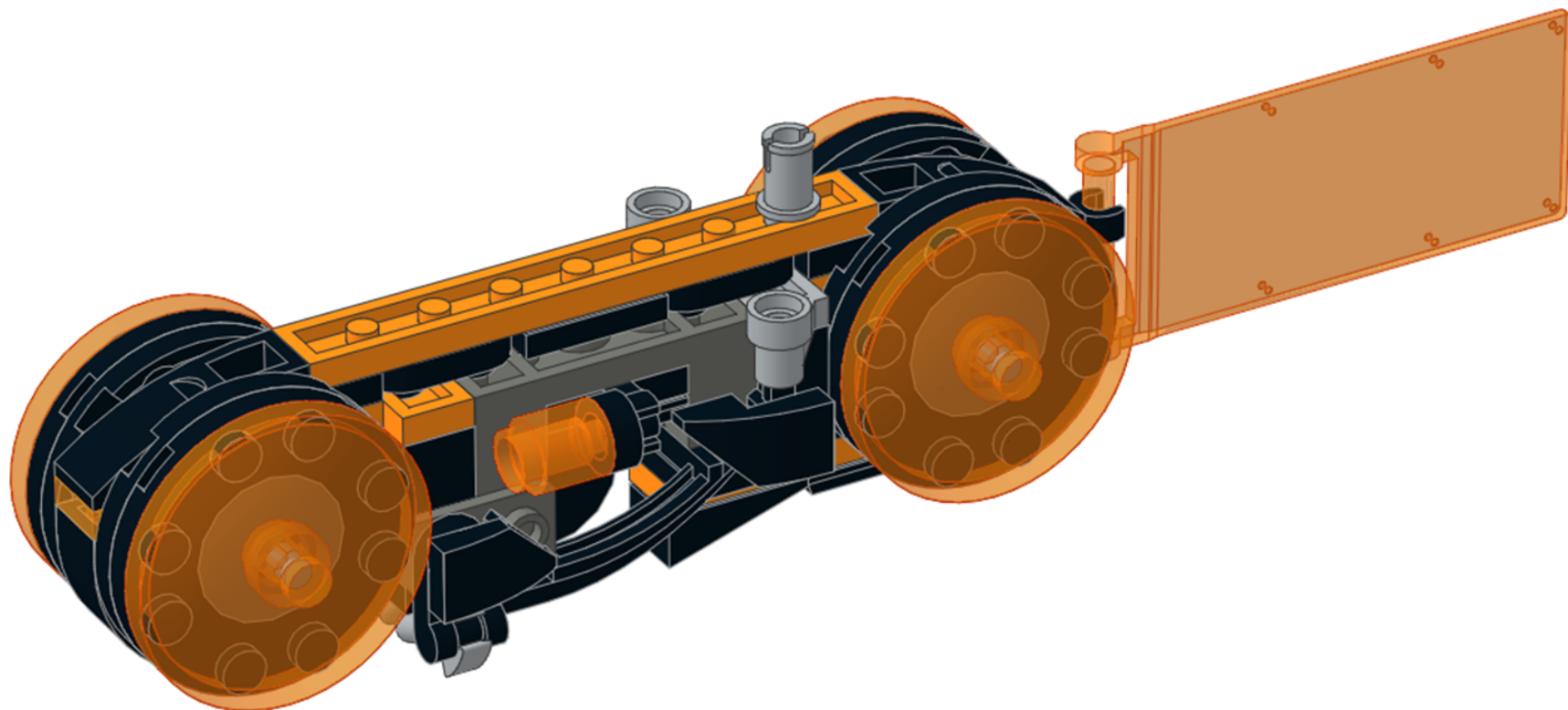

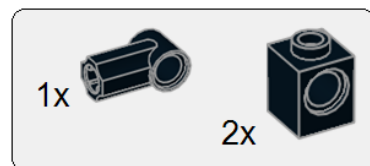

2

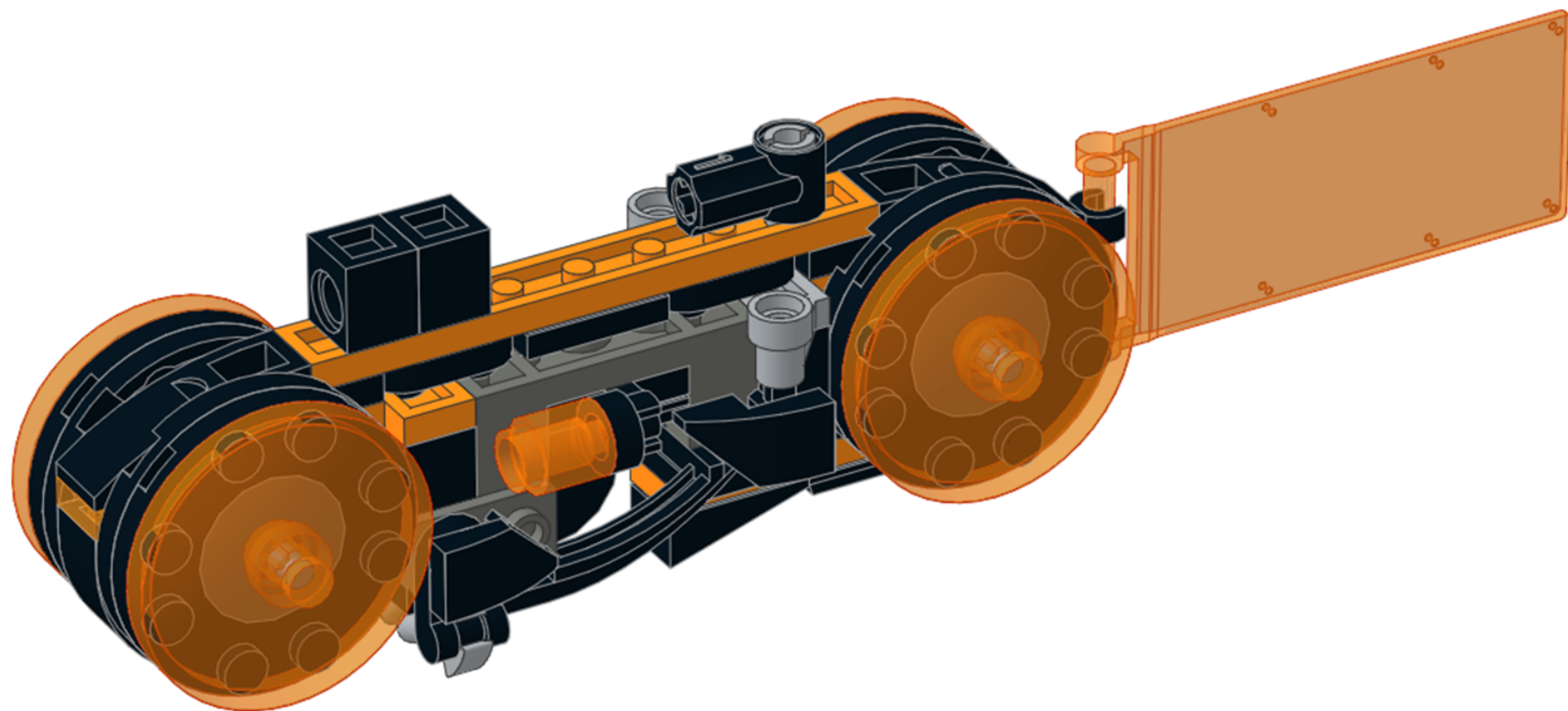



3

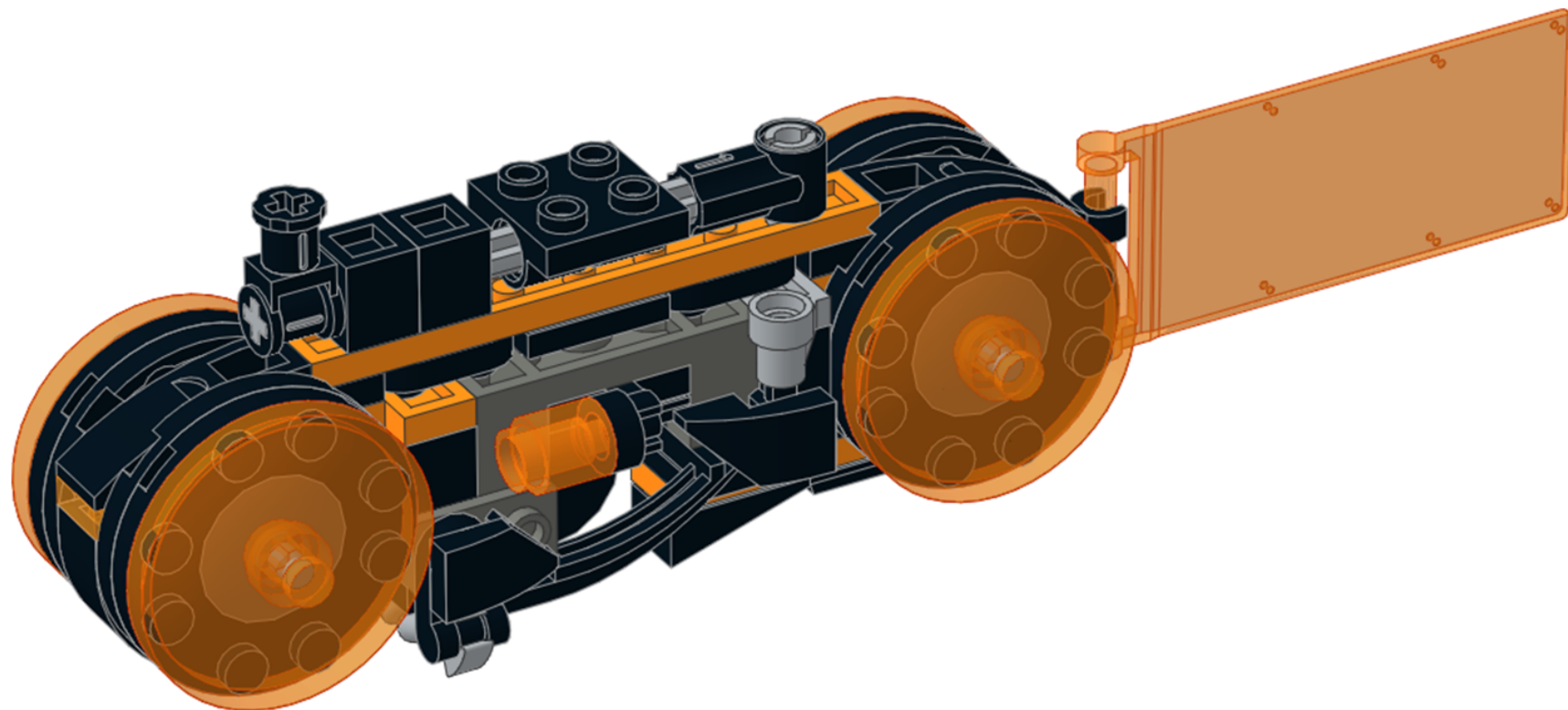

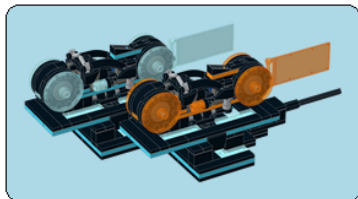

1x

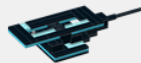

1x



1

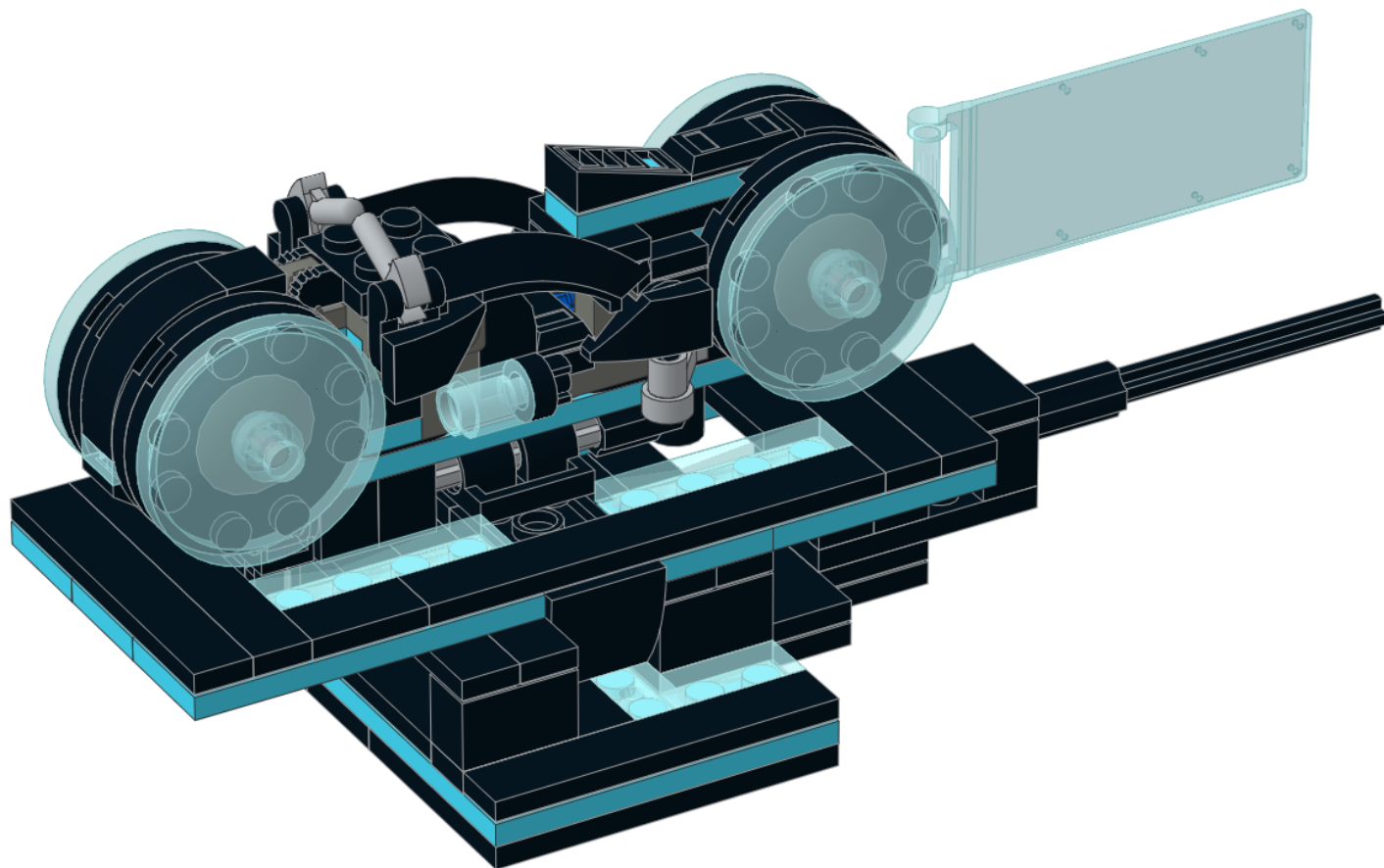



2

